

**CLPT-7230**  
**Compact Mega Top Prep Table**  
**Self-Contained Solid Doors**



**STANDARD PRODUCT FEATURES**

- High Quality Stainless Steel Construction
- Anodized Aluminum Interior
- Mega Top Pan Capacity for Extra Food Storage
- LED Display Control for Accuracy and Easy Monitoring
- Stay Open Door Feature at 105°
- Capillary Tube Metering Device
- 8" Deep, 3/4" Thick, Full Length Removable Cutting Board
- NSF Approved White Polyethylene Board
- Maintains Cabinet Temperature of 32°F to 41°F
- Insulated Hood
- NSF Rated for Use with 6" Deep Pans
- Top Cut-Out Accommodates 1/6 Size Pans (4" deep plastic pans provided)
- Two (2) Adjustable, Heavy Duty Epoxy Coated Shelves Per Section
- Field Reversible Door(s)
- Set of Four (6) 4" H Casters, Front Three w/ Locks, Pre-installed on Device
- Gasket-Protecting Retainer
- Self-Contained Rear-Mounted Refrigeration System
- High-Density, Non-CFC Foamed in Place Polyurethane Insulation



Models listed to the applicable UL, CSA and NSF standards by an approved NRTL. Consult the factory or unit data plate for additional information.

**ACCESSORIES & OPTIONS (Available at Extra Cost)**

- + Additional Epoxy Coated Shelves on Pilasters
- + Set of Six (6) 6" High Legs
- + Set of Six (6) 6" High Casters
- + Set of Six (6) 2-3/4" High Casters

**AVAILABLE CONFIGURATIONS**

**MODELS**

CLPT-7230-SD-LRR  
CLPT-7230-SD-LLL  
CLPT-7230-SD-RRR

**HINGING**

Solid Doors, Left/Right/Right  
Solid Doors, Left/Left/Left  
Solid Doors, Right/Right/Right

| Model     | Doors | Shelves | Pans (1/6) | Dimensions L x D x H (in.) | Voltage  | Amps | NEMA    | Cu. Ft. |
|-----------|-------|---------|------------|----------------------------|----------|------|---------|---------|
| CLPT-7230 | 3     | 6       | 30         | 72.5 x 35.75 x 40*         | 115/60/1 | 5.0  | 5 - 15P | N/A     |

\*Note: 40 in. height without casters

Approved by \_\_\_\_\_ Date \_\_\_\_\_ Approved by \_\_\_\_\_ Date \_\_\_\_\_

**MODEL - CLPT-7230**

Solid Door Models - Mega Top

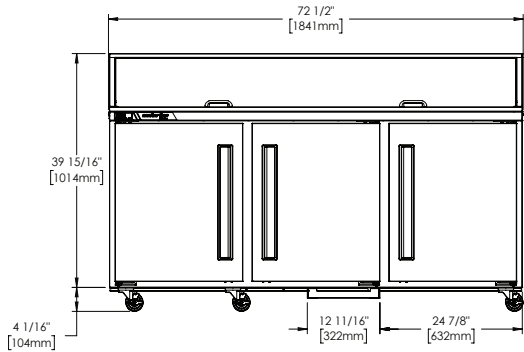

**ELEVATION**

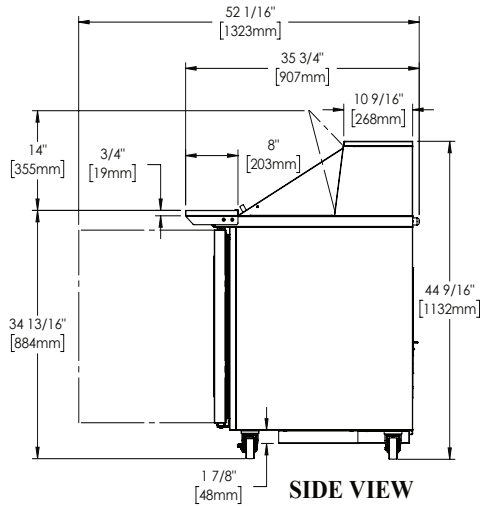

**SIDE VIEW**

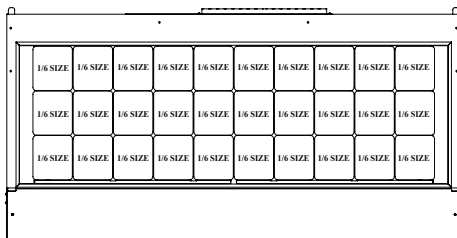

**PAN LAYOUT**

**SPECIFICATIONS**

**CONSTRUCTION, HARDWARE, INSULATION**

Cabinet exterior front, sides, and door(s) are constructed of stainless steel. Cabinet interior is constructed of anodized aluminum. 1/6 size plastic pans and a set of six (6) 4" high casters are included. Doors are equipped with a gasket protecting retainer. Both the cabinet and door(s) are insulated with an average of 2-3/8" thick high density, non-CFC, foamed in place polyurethane insulation.

**REFRIGERATION SYSTEM**

A rear mounted, self-contained, balanced refrigeration system using environmentally friendly, non-flammable R-450A refrigerant is provided. It features an easy to clean rear facing condenser, capillary tube metering device, and an air-cooled hermetic compressor. A 9' cord and plug is provided. Standard operating temperature is 32°F to 41°F. Energy efficient refrigeration system maintains safe product temperatures. Condenser is located in back of unit for easy maintenance and zero clearance.

**CONTROLLER**

The easy to use electronic digital control is supplied standard. It includes a 3-Digit LED display, and a Fahrenheit or Celsius temperature scale display capability.

**INTERIOR**

Standard interior arrangements include two (2) epoxy coated wire shelves per section, mounted on pilasters. Recommended load limit per shelf should not exceed 150 lbs.

**WARRANTY**

Both a 6 Year Parts & Labor Warranty and additional 1 Year on Compressor Parts Warranty are supplied standard.

| MODELS                     | CLPT-7230      |
|----------------------------|----------------|
| <b>ELECTRICAL DATA</b>     |                |
| Voltage                    | 115/60/1       |
| Full Load Amperes          | 5.0            |
| <b>REFRIGERATION DATA</b>  |                |
| Refrigerant                | R-450A         |
| Refrigerant Charge oz.     | 11.0 (312 gr)  |
| BTU/HR <sup>1</sup>   H.P. | 2134   1/4     |
| <b>SHIPPING DATA</b>       |                |
| Depth Crated in.           | 35 (88.9 cm)   |
| Height Crated in.          | 49 (124.5 cm)  |
| Length Crated in.          | 77 (195.6 cm)  |
| Volume Crated cu. ft.      | 76.4 (2164 l)  |
| Net Weight lbs.            | 367 (166.6 kg) |
| Gross Weight lbs.          | 408 (185.1 kg) |

**NOTES:**

1. BTU/HR based on a 90°F ambient and 20°F evaporator

Equipped with one NEMA 5-15P Plug

