

# "UBLD-21" UNDERBAR LIQUOR DISPLAY

## 21" Width

**FEATURES:**

- 18GA Stainless Steel Construction
- Type 300 Stainless Steel With #4 Polish, Satin Finish
- Standard Pre-Drilled Holes On Sides For Attaching Adjacent Units Together
- Stainless Steel Front To Back Bracing
- Angled Dividers For Labeling

**SPECIFICATIONS:**

- Top: 18GA Type 300 Stainless Steel
- Backsplash: 18GA Type 300 Stainless Steel
- Sides: 18GA Type 300 Stainless Steel
- Bolt On 1-5/8" Stainless Steel Legs For Fast Installation
- 1-1/4" Front To Back Bracing
- 1" Adjustable Stainless Steel Bullet Feet
- Z-Clip To Mount To Wall
- Bolt To Adjacent Underbar Piece
- Mounting Options Allow For Flexible Installation
- Options To Remove Back Or Front And Back Legs For A Clean Installation

**CERTIFICATIONS:**



UBLD-2124

### ACCESSORIES

MODEL	DESCRIPTION
UBSS-21-L	Left Hand Side Splash
UBSS-21-R	Right Hand Side Splash

### "UBLD-21" UNDERBAR LIQUOR DISPLAY

MODEL	SIZE (LXWXH)	LENGTH (L)	WEIGHT (LBS)
UBLD-2112	12"x21"x32-1/2"	12"	31
UBLD-2118	18"x21"x32-1/2"	18"	36
UBLD-2124	24"x21"x32-1/2"	24"	41

ALL DIMENSIONS ARE TYPICAL. TOLERANCE +/- .500". JOHN BOOS & CO. RESERVES THE RIGHT TO CHANGE SPECIFICATIONS WITHOUT NOTICE.

# DETAILED SPECIFICATIONS

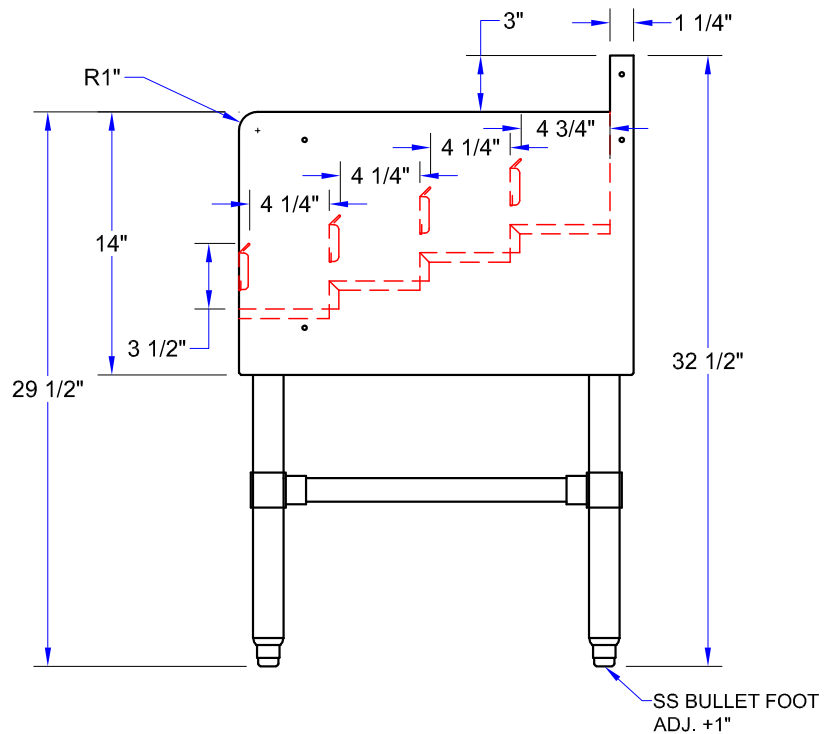
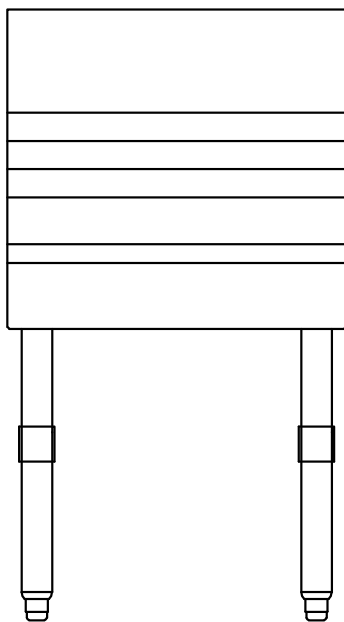
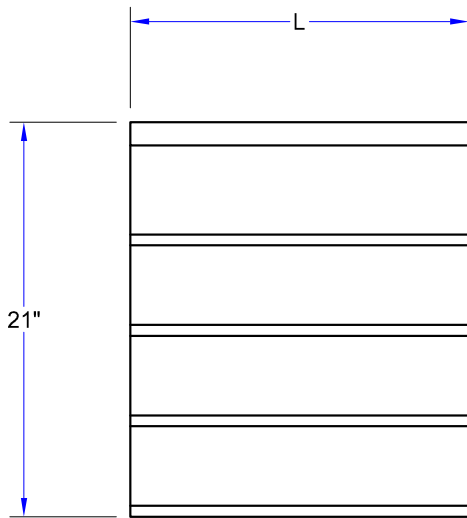

## "UBLD-21" UNDERBAR LIQUOR DISPLAY

MODEL	SIZE (LXWXH)	LENGTH (L)	WEIGHT (LBS)
UBLD-2112	12"x21"x32-1/2"	12"	31
UBLD-2118	18"x21"x32-1/2"	18"	36
UBLD-2124	24"x21"x32-1/2"	24"	41

ALL DIMENSIONS ARE TYPICAL. TOLERANCE +/- .500". JOHN BOOS & CO. RESERVES THE RIGHT TO CHANGE SPECIFICATIONS WITHOUT NOTICE.